

MOAT DRIVE, NORTH HARROW



Three Bedroom Semi Detached House

Guide Price £750,000

Description

A beautifully presented three double bedroom semi detached property situated in this highly regarded cul-de-sac location close to shopping and transport facilities in North Harrow and Harrow. Comprising: Porch, hallway, lounge, dining area, extended fully fitted kitchen, utility area, downstairs Cloakroom, the three generously proportioned bedrooms and shower room with separate WC to the first floor. Outside to the rear is a very pretty rear garden and the front provides off street parking.





- *Extended semi detached house with three double bedrooms*
- *Gas central heating and double glazed windows*
- *Viewing highly advised*
- *Through lounge, extended kitchen, study and downstairs cloakroom*
- *Cul-de-sac location close to facilities*



Additional Information

TENURE: FREEHOLD

LOCAL AUTHORITY: LONDON BOROUGH OF HARROW

ENERGY EFFICIENCY RATING: D

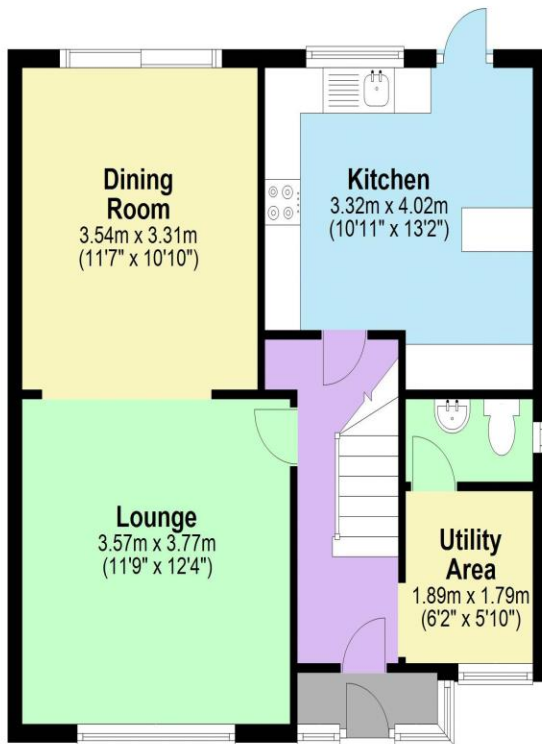

Ground Floor
Approx. 50.0 sq. metres (538.5 sq. feet)

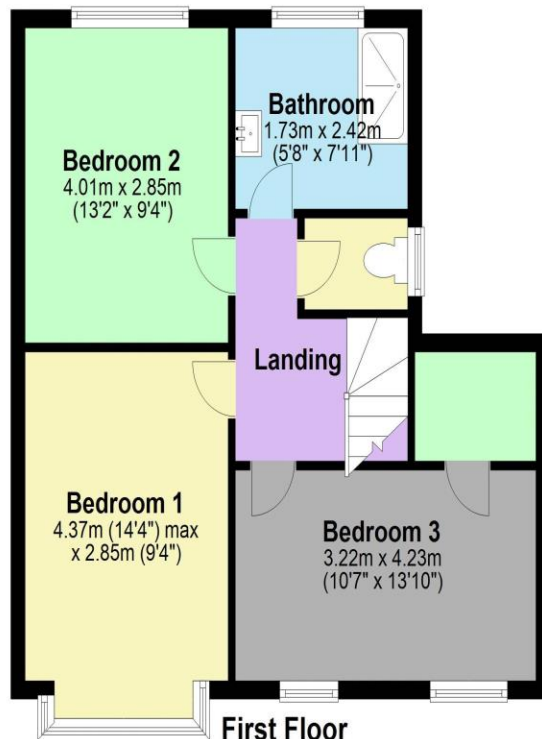

First Floor
Approx. 45.0 sq. metres (484.4 sq. feet)

Total area: approx. 95.0 sq. metres (1022.9 sq. feet)

Score	Energy rating	Current	Potential
92+	A		
81-91	B		85 B
69-80	C		
55-68	D	65 D	
39-54	E		
21-38	F		
1-20	G		



We have not sought to verify the legal title of the property, the existence of planning permissions and/or building regulation approvals and have been unable to check the working condition of any services or appliances.

Property layouts are for general guidance and are not drawn exactly to scale. Measurements are taken at the widest points and bays, alcoves, wardrobes etc. may not be shown.